

**FIRST ANNOUNCEMENT AND CALL FOR ABSTRACTS: XXVIIIth  
CONFERENCE OF THE INTERNATIONAL SOCIETY  
FOR FLUORIDE RESEARCH  
FLUORIDE: BONE AND BRAIN EFFECTS  
AUGUST 7-10, 2008 – TORONTO, CANADA**

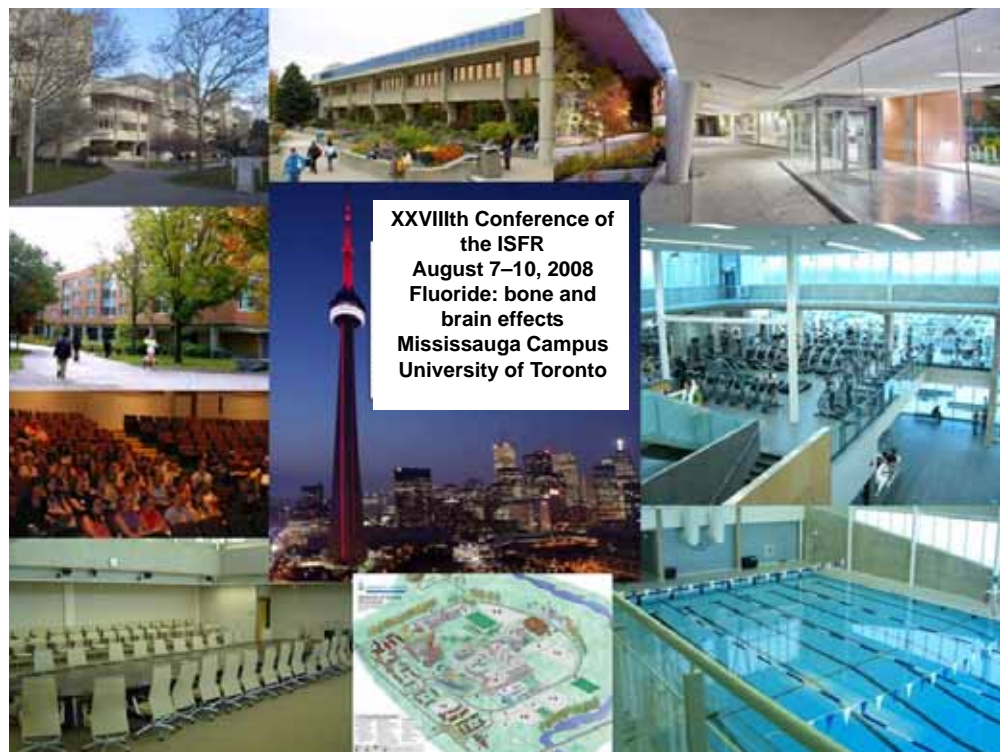

**INTRODUCTION**

At the highly successful XXVIIth ISFR Conference held in Beijing, October 9-12, 2007, it was proposed by several members and decided by a strong majority vote to hold the XXVIIIth ISFR Conference in North America, where it will be held at the Mississauga Campus of the University of Toronto, August 7-10, 2008. The previously planned 2009 date for the XXVIIIth conference in India has been changed to be the XXIXth conference for the year 2010, hosted by Dr. Jashwanti D Sharma, Department of Zoology, University of Rajasthan, Jaipur, India. The XXVIIIth conference will be hosted by Associate Professor Hardy Limeback, Head of Preventive Dentistry, Faculty of Dentistry, University of Toronto (Figure 1).



**Figure 1.** Associate Professor Hardy Limeback, PhD, DDS. Head of Preventive Dentistry, Faculty of Dentistry, University of Toronto, Toronto, Ontario, Canada.

## CONFERENCE TITLE

The title of the conference is **Fluoride: bone and brain effects**. However, all aspects of the effects of fluoride on human and animal health will be discussed. Further program information will be posted in the next announcement. Professor AK Susheela, PhD, FAMS (India), FASc, Ashoka Fellow, Executive Director, Fluorosis Research and Rural Development Foundation, Delhi, India, has accepted an invitation to be a keynote speaker.

## CONFERENCE ORGANIZING COMMITTEE

The *Conference Organizing Committee* comprises:

### Conference Organizer and Host:

Associate Professor Hardy Limeback, 1060 Springhill Drive, Mississauga, Ontario, Canada, L5H 1M9.

Phone/ Fax: 905 891 6777

E-mail: Hardy.Limeback@dentistry.utoronto.ca

### Conference Manager:

Gale Richter,

Conference Manager, University of Toronto Mississauga

Phone: 905 828-5279; Fax: 905 569-4637

E-mail: gale.richter@utoronto.ca

### Advisors:

Professor Jörg Spitz, ISFR Immediate Past President, Society for Medical Information and Prevention, Wiesbaden, Germany. E-mail: info@mip-spitz.de.

Professor Emeritus Albert Burgstahler, Editor *Fluoride*, the University of Kansas, Lawrence, KS, USA. E-mail: awburg@ku.edu.

Professor Emeritus Paul Connett and Ellen Connett, St. Lawrence University, Canton NY, USA. E-mail: paul@fluoridealert.org.

Dr Bruce Spittle, Managing Editor *Fluoride*, Dunedin, New Zealand. E-mail: spittle@es.co.nz.

## VENUE

The XXVIIIth ISFR Conference will be held on the beautiful rural Mississauga campus of the University of Toronto (see composite above). Toronto, the capital city of Ontario, the financial center and “engine” of Canada, is a large multi-cultural city with over 2.5 million people, half of whom were born in another country. Toronto lies on the north shore of Lake Ontario, one of the Great Lakes of North America shared by the USA and Canada. It is part of the ‘Golden Horseshoe’, a string of cities with over 6 million people found on the east shore of Lake Ontario from the east side of Toronto to Niagara Falls. Toronto ranks 14th in the world for tourism. It has internationally renowned theatres, opera, ballet, film festivals, museums (science, culture, art), amusement parks, recreational parks and, of course, professional sports (home of the National Basketball Association Toronto Raptors, the Toronto Maple Leafs, the World Series-winning Toronto Blue Jays, and the Canadian Football League’s Toronto Argonauts, who will be practicing on the sports fields of the Mississauga Campus at the same time as the ISFR conference).

Mississauga, a bedroom/industrial community located 20 km southwest of downtown Toronto, is a suburb of Canada’s sixth largest city. Travelers coming to

Toronto by air will arrive at the Lester B. Pearson International Airport located near Malton about 15 km north of Mississauga. There is an indirect 2-hour trip by public bus (one transfer) to the Mississauga Campus of the University of Toronto (only \$2.50 CAN) or a 20-minute \$40 airport taxi-limousine ride to the campus.

### CALL FOR ABSTRACTS

Papers and poster presentations are invited on subjects and issues concerning research and practical topics relating to fluoride. Papers can only be accepted and published when at least one of the authors is registered to attend the conference. All abstracts will be published in the Conference Proceedings, one copy of which will be given to each participant during registration. Depending on space limitations, it is planned to publish as many of the abstracts as possible in *Fluoride*.

*Submission of Abstracts:* Conference abstracts, written in clear, concise English, with 3 to 5 keywords and a maximum of 20 words in the title and 350 words in the text, should be submitted to Professor Limeback by E-mail by June 30, 2008. Late abstract submissions (for posters only) will be accepted with a commitment to attend the conference (advanced registration). The abstracts should be written following, uniformly and exactly, the style of those for the XXVIth Conference, as published in *Fluoride* 2005;38(3):220-59, [www.fluorideresearch.org,.com and.net](http://www.fluorideresearch.org,.com and.net), except that 12-point Times New Roman type should be used throughout. The name of the presenter should be in bold type and whether an oral (platform) or poster presentation is preferred should be stated. Oral presentations are limited to 15 minutes. Presentations will be in English. Computers and projectors equipped for Powerpoint presentations will be available in all meeting rooms. Poster dimensions should not exceed 1 m in width or 1.2 m in height. Authors of poster presentations will be informed at the registration where and when their posters will be located and when they should be removed. Mounting materials will be provided. Exhibits of products and technology exhibits relating to fluoride research will be arranged at the venue. Firms interested in exhibiting are invited to apply to Professor Limeback. The ISFR is strictly a scientific research organization without any commercial ties or support.

*Correspondence:* For questions about abstract submissions, poster presentations and exhibits contact Professor Limeback ([Hardy.Limeback@dentistry.utoronto.ca](mailto:Hardy.Limeback@dentistry.utoronto.ca)).

### REGISTRATION

*Pre-registration:* The cost of registration, accommodation and food will range from between CAN\$450 and CAN\$600 in total, depending on choice of accommodations and length of stay. The conference finishes with the gala farewell banquet on the evening on Saturday August 9 but instead of departing on the morning of Sunday August 10, two additional options are available. One is to attend a post-conference Niagara tour: “Niagara: See the Falls and Taste the Wine” and the other is to attend the FAN III conference on Sunday August 10. The tour is still being planned and may not get back until the mid-evening. However both those visiting Niagara and those attending FAN III may extend their

accommodation to include the evening of Sunday August 10 and check out on Monday August 11. Accompanying persons who do not attend the scientific meeting will be asked to register as guests for a nominal administrative fee.

*On-site conference registration* will be available August 7, 2008, at the Visitor Center on the Mississauga Campus. An early bird discount of CAN or US\$50, is available to those who register on or before June 30, 2008. The full registration fee will apply for registrations on or after July 1, 2008. The full fee will apply to mail registrations received on or after July 1 and to on-site registrations. All registrants prepaying the registration fee (CAN or US\$125) by the abstract deadline will, therefore, qualify for the early bird discount, (CAN or US\$50 for participants, CAN or US\$25 for students and accompanying persons).

| Registration Fees     |  |   |
|-----------------------|--|---|
| Category              | Early bird rate, on or before<br>June 30, 2008 | Full rate, on or later<br>than July 1, 2008 |
| Participants*         | CAN or US\$125                                 | CAN or US\$175                              |
| Students*             | CAN or US\$50                                  | CAN or US\$75                               |
| Accompanying persons† | CAN or US\$50                                  | CAN or US\$75                               |

\*Entitled to attend the welcome reception, opening ceremony, scientific sessions, exhibition, conference banquet, coffee/tea breaks, lunches, and the conference banquet, and to receive a copy of the conference proceedings.

†Entitled to attend the welcome reception, opening ceremony, coffee/tea breaks, and the conference banquet but not the scientific sessions, exhibition, or lunches and will not receive a copy of the conference proceedings.

Participants and students will receive a conference folder with a copy of the conference proceedings (schedule and abstracts) and tickets for the welcome reception, lunches, and the conference banquet. Accompanying persons who register will receive tickets for the welcome reception and the conference banquet. Separate tickets for the ISFR tour: “Niagara: See the Falls and Taste the Wine” will be sold in advance (deadline July 31, 2008). Seating will be limited.

Please complete the Conference Registration Form on page 213 after photocopying the page or downloading it from the websites [www.fluorideresearch.org](http://www.fluorideresearch.org) (or .com, or .net) or write a letter containing the information, and submit it, by E-Mail, before June 30, 2008, to Professor Limeback. Confirmation of registration will be made by return E-mail. We encourage everyone to take advantage of the student facilities since the social events will all be on campus, especially the impromptu social gatherings in the student lounges. Nevertheless, a list of nearby hotels and information for making hotel reservations will be provided upon request to Professor Limeback.

*Payment:* Payment in Canadian dollars is preferred, as conference accounts will be paid in CAN\$, but US dollars will also be acceptable. Please send a bank draft or cheque made out to “Dr Hardy Limeback, ISFRXXVIII Conference Organizer” by registered mail to: Associate Professor Hardy Limeback, 1060 Springhill Drive, Mississauga, Ontario, Canada, L5H 1M9, accompanied by the Conference Registration Form or a letter containing the information. If advance notice is given

to Professor Limeback, participants may also pay the registration fee by cash or travellers cheques at the registration desk at the time of registration.

*Letters of Invitation* will be sent on request to the conference organizer but no financial support for attendance is available.

### CAMPUS ACCOMMODATION

*Accommodation* for participants and accompanying persons (spouses, guests, children) should be reserved in advance. There are two types of accommodations available: apartments and student rooms in residence buildings. In the apartments, 4 bedrooms share a kitchenette, living area and two bathrooms. In the student rooms, 2 student residence rooms share a washroom (Figures 2 and 3). These are new student residences and are luxurious in comparison to other universities. More details about accommodations and information about meals will be provided in the Second Announcement.

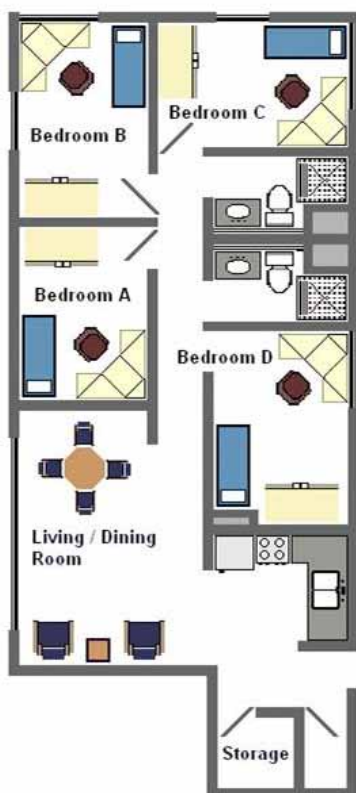

**Figure 2.** Apartment shared accommodation.

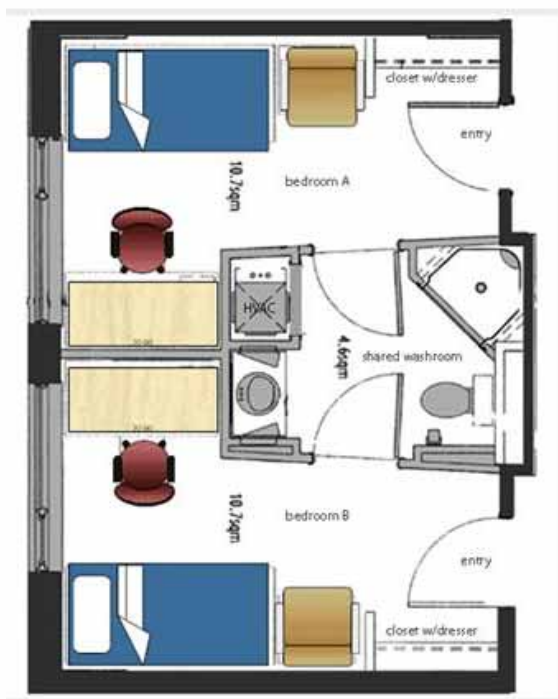

**Figure 3.** Student rooms. Adjoining residence rooms with shared washroom.

### GENERAL INFORMATION AND IMPORTANT DATES

The Canadian dollar is experiencing unprecedented strength relative to the US dollar (currently almost at par) but has not increased in value as much against other foreign currencies. Most tourists still find Canada a bargain and Toronto a great place to shop.

Deadline for abstract acceptance: 30 June 2008

Deadline for early bird rate for registration: 30 June 2008

Deadline for reservation of the Niagara tour: July 31, 2008.

## PROVISIONAL CONFERENCE PROGRAMME

| Date                 | Time                     | Participants   | Spouses and guests             |
|----------------------|--------------------------|--|--------------------------------|
| Thursday<br>August 7 | All day<br>1900          | Registration at check-in desk, Visitor Centre,<br>Mississauga Campus<br>Welcome reception  |                                |
| Friday<br>August 8   | To be notified           | Breakfast and poster set-up  |                                |
|                      | To be notified           | Opening ceremony   |                                |
|                      | Morning                  | Scientific session<br>Brain and endocrine effects<br>Evidence that fluoride reduces IQ in humans<br>Does fluoride interfere with the thyroid?<br>Lunch   | Free time                      |
|                      | 1200–1300<br>Afternoon   | Scientific session<br>Evidence for fluoride's benefits<br>An update on recently published fluoridation studies<br>Fluoridation cessation studies<br>Topical benefits of fluoride<br>Poster viewing<br>ISFR Executive meeting | No lunch provided<br>Free time |
|                      | 2000                     | Bar-B-Q patio dinner and excursion to downtown<br>Toronto  |                                |
| Saturday<br>August 9 | Morning                  | Scientific session<br>Key note presentation: Professor AK Susheela:<br>India's struggle with the prevention of skeletal<br>fluorosis<br>Skeletal fluorosis in China<br>Occupational exposure to fluoride                     | Free time                      |
|                      | 1200–1300<br>Afternoon   | Lunch<br>Scientific session<br>Oral and poster presentations<br>Panel discussion   | No lunch provided<br>Free time |
|                      | 2000                     | Gala farewell banquet at Faculty Club  |                                |
|                      |                          |  |                                |
| Sunday<br>August 10  | Morning                  | Departure for those not going on the Niagara tour or attending the FAN III<br>conference<br>FAN III conference   |                                |
|                      | 1100<br>Around<br>midday | Post-conference tour: "Niagara: See the Falls and Taste the Wine."<br>Lunch as part of the Niagara tour or FAN III conference  |                                |
|                      | Afternoon and<br>evening | Niagara tour or FAN III conference. The Niagara tour itinerary is still be<br>planned and the finishing time has not yet been finalized. It is likely to be<br>between late-afternoon and mid-evening.                       |                                |
| Monday<br>August 11  | Morning                  | Departure for those who requested an additional night's accommodation in<br>order to attend the Niagara tour or the FAN III conference   |                                |

# THE XXVIIIth CONFERENCE OF THE INTERNATIONAL SOCIETY FOR FLUORIDE RESEARCH (ISFR XXVII), AUGUST 7-10 2008, TORONTO, CANADA

## CONFERENCE REGISTRATION FORM

(Please photocopy, download from [www.fluorideresearch.org](http://www.fluorideresearch.org), .com, or .net, or give the information in a letter or E-mail. Type or print clearly. Please fill out the entire form.)

First name: \_\_\_\_\_ Initial \_\_\_\_\_

Last name: \_\_\_\_\_ Title: \_\_\_\_\_

Nationality: \_\_\_\_\_ Organization: \_\_\_\_\_

Mailing address: \_\_\_\_\_

Postal code: \_\_\_\_\_ Country: \_\_\_\_\_

E-mail: \_\_\_\_\_

Telephone: \_\_\_\_\_ Fax: \_\_\_\_\_

Names of accompanying persons: \_\_\_\_\_

Accommodation: Which accommodation do you prefer? (The 2-bedroom apartment residences are cheaper. The accommodation can be paid for at the check-in desk on arrival.)

4-bedroom apartment \_\_\_\_\_ 2-bedroom student room \_\_\_\_\_

Do you wish to present a paper? \_\_\_\_\_

If yes, what is the title? \_\_\_\_\_

Do you prefer an oral or poster presentation? \_\_\_\_\_

(Abstracts need to be sent as a Word document attachment by June 30, 2008. Late abstracts will be accepted if accompanied by payment of the registration fee at the full rate, on or after July 1, 2008.)

| Registration fees as listed in the adjacent table:  | Category             | Early bird rate on or before June 30, 2008 | Full rate, on or after July 1, 2008 |
|---|----------------------|--|-------------------------------------|
| (Payment in Can\$as preferred, as the conference accounts need to be paid in Canadian dollars, but US\$ will also be acceptable.) | Participants         | CAN or US\$125                             | CAN or US\$175                      |
|   | Students             | CAN or US\$50                              | CAN or US\$75                       |
|   | Accompanying persons | CAN or US\$50                              | CAN or US\$75                       |

Total registration fee due US\$= \_\_\_\_\_

Do you wish to go on the post-conference tour "Niagara: See the Falls and Taste the Wine"?

Yes \_\_\_\_\_ No \_\_\_\_\_

Do you wish to have an additional night's accommodation for the night of August 10, 2008 in order to attend the Niagara tour or the FAN III conference?

Yes \_\_\_\_\_ No \_\_\_\_\_

Please send the information by E-mail, before June 30, 2008 if possible, to Professor Limeback.

E-mail: [Hardy.Limeback@dentistry.utoronto.ca](mailto:Hardy.Limeback@dentistry.utoronto.ca)

Payment should be preferably be paid in Canadian dollars, but US dollars will be accepted, by bank draft or cheque made out to "Dr Hardy Limeback, ISFRXXVIII Conference Organizer" and sent by registered mail to Professor Limeback accompanied by the conference registration form or a letter containing the information. If advance notice is given to Professor Limeback, participants may also pay the registration fee by cash or travellers cheques at the registration desk at the time of registration. Address: Associate Professor Hardy Limeback, 1060 Springhill Drive, Mississauga, Ontario, Canada, L5H 1M9.